

ATTACHMENT B

## **ATTACHMENT B**

**DEVELOPED DESIGN EXHIBITION PANELS**



# 1 Have Your Say on Kent Street Underpass Upgrade

## Introduction

The Kent Street Underpass is a key link between the city, Harbour Village North and Barangaroo. It is a network of underground walkways, bike links and spaces under the Western Distributor between Grosvenor and Kent Streets.

The City of Sydney is planning to improve the area to make it easier to use and more appealing. The Kent Street Underpass was identified as a priority project in the Harbour Village North Public Domain Study.

In June and July 2014, the City exhibited concept designs for the Kent Street Underpass upgrade. Community feedback has been incorporated into the developed design.

## Key changes in the developed design

### Access

The existing stairs will be replaced with wider stairs to improve access from Kent Street and make it easier for more people to walk to and from Barangaroo.

### Use

Playful elements such as musical chimes and lighting will be located in the tunnels to engage people as they move through the underpass.

Power supply will allow for small scale temporary events.

### Safety and surveillance

The footpath leading to Kent Street has been redesigned and new signs added to help better separate people walking and riding bikes.

### Cycleway Improvements

The separated cycleway has been increased.

### Planting

Tree and understorey planting has been increased to provide a more attractive green place.

## Feedback

The revised design is on exhibition until 10 May 2015. Please provide feedback online at [sydneyyoursay.com.au](http://sydneyyoursay.com.au)

Documents can also be viewed in person at:

One Stop Shop (CBD)  
Level 2, Town Hall House, 456 Kent Street, Sydney  
Monday to Friday: 8am to 6pm

Harry Jensen Community Centre  
17 Argyle Street, Millers Point NSW 2000  
Monday to Friday: 9:30am to 3:30pm

All feedback received during the public exhibition will be reported to Council.

## Contact

For more information, please contact Kristin Gabriel, Senior Community Engagement Coordinator on 02 9265 9333 or email [kgabriel@cityofsydney.nsw.gov.au](mailto:kgabriel@cityofsydney.nsw.gov.au)

Postal address:  
City of Sydney, GPO Box 1591 Sydney 2001.  
Contacting us through our website on [sydneyyoursay.com.au](http://sydneyyoursay.com.au)

General enquiries call 02 9265 9333

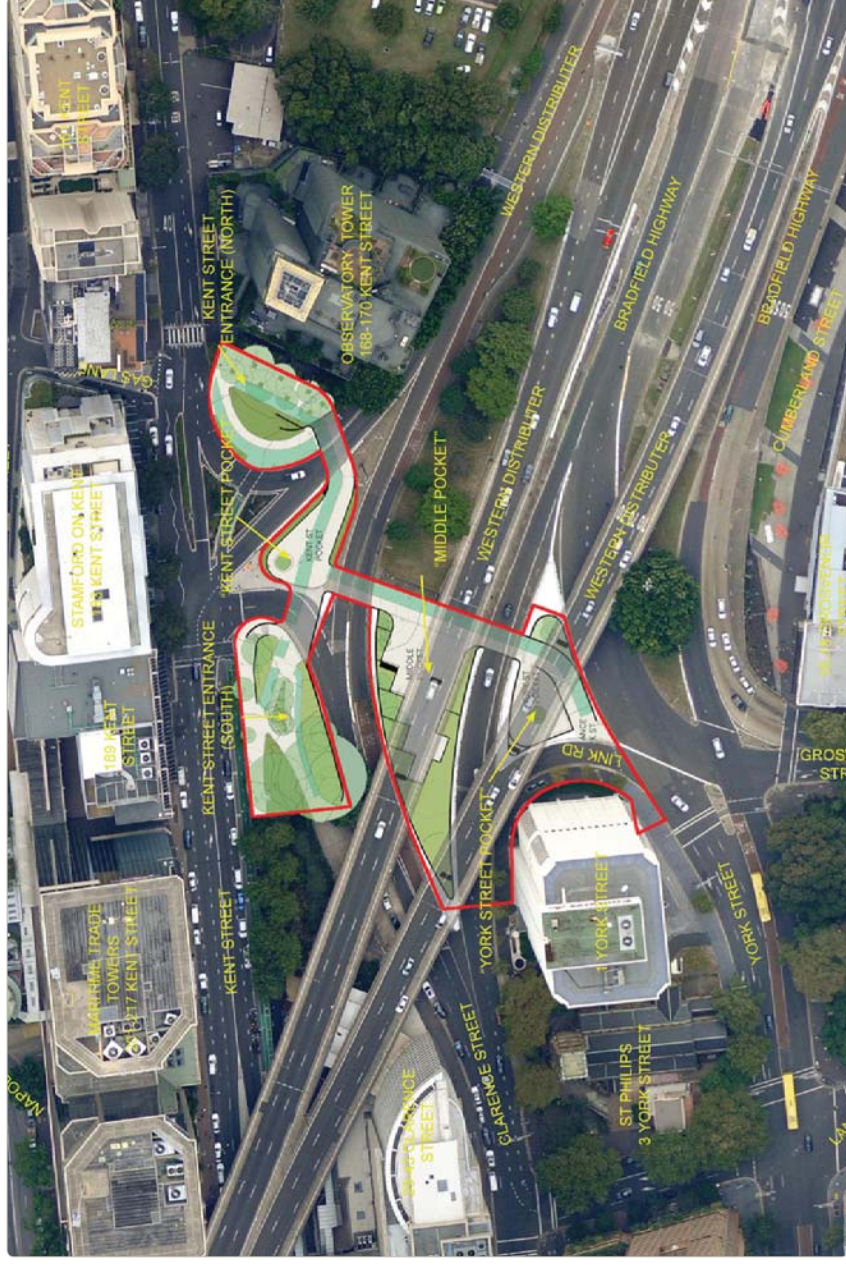

Aerial view of the Kent Street Underpass

## Next Steps



## Key design ideas

**1**  
The existing site

**2**  
**Declutter**  
Removing some of the existing structures, such as the raised planters and terraces, will help 'open up' the space. This will improve sightlines which will increase the feeling of safety and security.

**3**  
**Landform**  
The ground will be made up of textured paving, extending into low planting with a mixture of colourful groundcovers and low strap-leaved plants.

**4**  
**Walking and riding**  
The cycleway is clearly separated from the pedestrian areas through a 150mm set down and change of colour in the paving.

**5**  
**Trees**  
Tall, straight palm trees break the horizontal lines of the walls and bridges and provide visual links through the spaces.

**6**  
**Playfulness**  
Musical chimes and a pattern of strip lights on the tunnel walls create playful interludes for pedestrians on their journey through the underpass.



## Developed Design Plan

**LEGEND**

- New planting
- Existing planting
- Stone paving
- Shared Zone
- Separated cycleway
- Cycle lane at street level
- Bitumen footpath
- Bollard
- Drain
- New palm tree
- New canopy tree
- Re-located palm
- Existing tree to be retained
- Tree to be removed
- Tree to be re-located
- Contours





View from the middle pocket looking east



View looking through the tunnel to the Kent Street Pocket.



## Play

Musical chimes fixed to tunnel walls and a pattern of strip lights will create a playful journey for people walking through the underpass.

The chimes will be securely mounted and will be finished with an anti-graffiti coating.

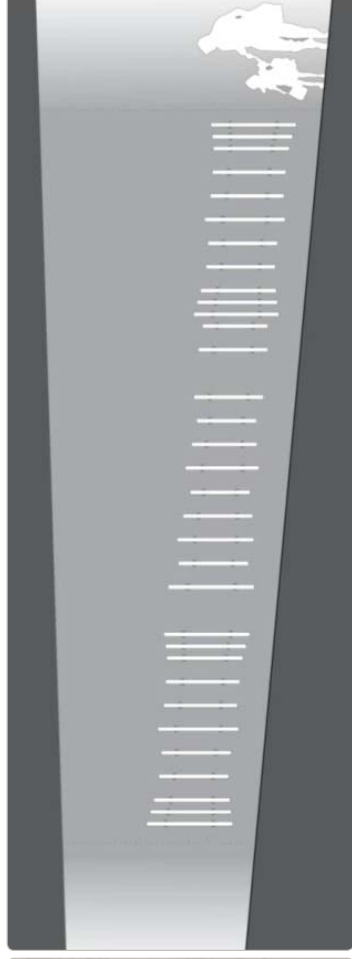

Musical chimes mounted on the tunnel walls beside the pedestrian path - arranged to play a tune or arranged in scales

## Lighting, Furniture and Materials

### Lighting

New lighting will improve pedestrian safety and add character to the area.

### Furniture

A low concrete retaining wall doubles as a seat in the Kent Street Pocket.

Bollards define the area shared by pedestrians, cyclists and vehicles in the shared zone.

### Paving

High quality stone paving will be used, with different pattern and colours to differentiate between pedestrian, cycleway and shared zones.



Strip lighting fixed to tunnel ceilings and walls



Inground-up lighting for palm trees



Spot lighting



City of Sydney Standard Bollard



Pedestrian areas Type 1 Porphyry paving



Cycleway Type 2 Porphyry paving and bluestone



Shared Zone Granite paving



## Planting

Twenty seven (27) new Cabbage Tree Palms will be planted to bring new life into the area. Garden beds around the site will also be upgraded to improve the overall appearance of the underpass and make it a more welcoming space.



Cabbage Tree Palm (*Livistona australis*)



Tall-Mondo-Grass (*Ophiopogon japonicus*)



Royal Purple (*Liriope muscari*)



Japanese iris (*Iris bicolor*)



Bush lily (*Clivia miniata*)



Moses in the cradle (*Rhoeo discolor*)



Mother in laws tongue (*Sansevieria trifasciata*)



Xanadu (*Philodendron xanadu*)



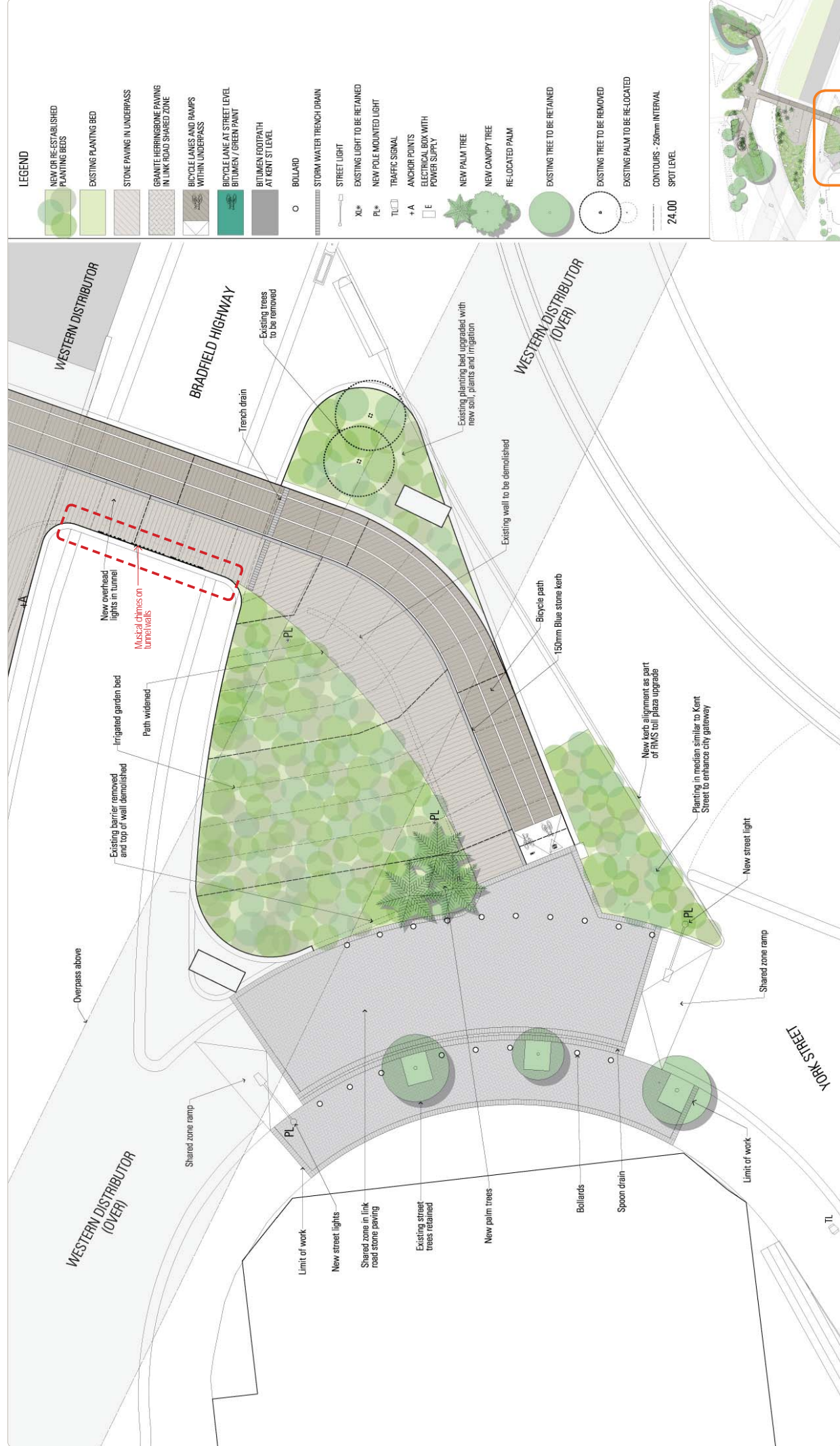

York Street Pocket Detail Plan

Key Plan



- LEGEND**
- NEW OR RE-ESTABLISHED PLANTING BEDS
  - EXISTING PLANTING BED
  - STONE PAVING IN UNDERPASS
  - GRANITE TERRAZZO PAVING IN LINK ROAD SHARED ZONE
  - BICYCLE LANES AND RAMPS WITHIN UNDERPASS
  - BICYCLE LANE AT STREET LEVEL BITUMEN / GREEN PAINT
  - BITUMEN FOOTPATH AT KENT ST LEVEL
  - BOLLARD
  - STORM WATER TRENCH DRAIN
  - STREET LIGHT
  - EXISTING LIGHT TO BE RETAINED
  - NEW POLE MOUNTED LIGHT
  - TRAFFIC SIGNAL
  - ANCHOR POINTS
  - ELECTRICAL BOX WITH POWER SUPPLY
  - NEW PALM TREE
  - NEW CANOPY TREE
  - RE-LOCATED PALM
  - EXISTING TREE TO BE RETAINED
  - EXISTING TREE TO BE REMOVED
  - EXISTING PALM TO BE RELOCATED
  - CONTOURS - 250mm INTERVAL
  - SPOT LEVEL
  - 24.00





Key Plan

Middle Pocket Detail Plan



Kent Street South Entry Detail Plan

Key Plan







**Kent Street Pocket Detail Plan**